

LED TROFFER FIXTURE(New Construction)

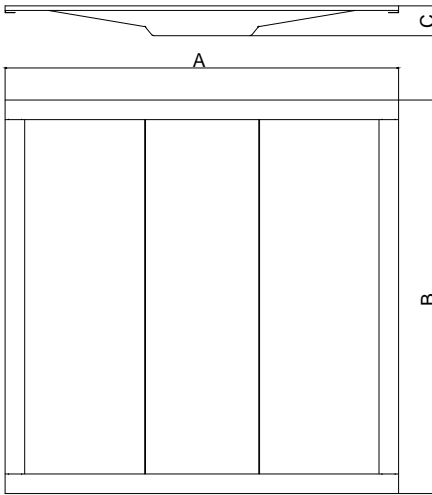

Maximum overall	A	B	C
2*2ft	603mm	603mm	45mm
2*4ft	603mm	1213mm	45mm



FEATURES

Input voltage:	AC100-277V
Operating frequency:	50/60Hz
Power factor:	> 0.95
Ambient temperature range:	-20°C ~+45°C
Color Temp:	3000K/4000K/5000K
Dimmable:	3-in-1 dimming
THD:	≤10%
IP Rating:	IP40
CRI:	>Ra80
Beam angle:	120°

- Cloud series led troffer gives >125lm/W
- Cloud series troffer can work with emergency power pack.
- Suitable for Damp Location
- 5 years' warranty .

PARAMETER

Length	Product code	Certification	CRI	Wattage	Description Function	Lumens 3000/4000/5000K	Packing/carton	
								G.W./carton
2x2ft	ZS-TF2*2-Q01-S40-3050	ETL/cETLus,DLC,	>80	20/30/40W	3-in-1 dimming(0-10V;PWM;Rx) CCT Tunable & Power adjustable	2500-5000 LM	640*120*640mm 2 pieces 1*40HQ Loading=2736pcs	7kg
							640*230*640mm 4 pieces 1*40HQ Loading=2880pcs	13kg
2x4ft	ZS-TF2*4-Q01-S60-3050	ETL/cETLus,DLC,	>80	40/50/60W	3-in-1 dimming(0-10V;PWM;Rx) CCT Tunable & Power adjustable	5000-7500 LM	1250*120*640mm 2 pieces 1*40HQ Loading=1368pcs	12.2kg
							1250*230*640mm 4 pieces 1*40HQ Loading=1440pcs	23kg

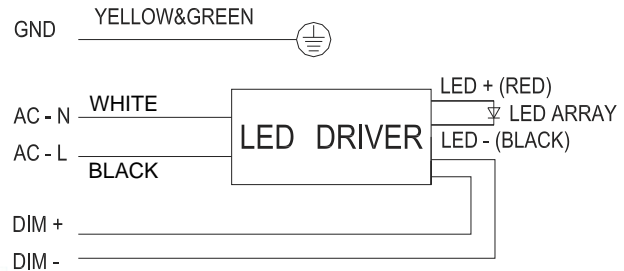
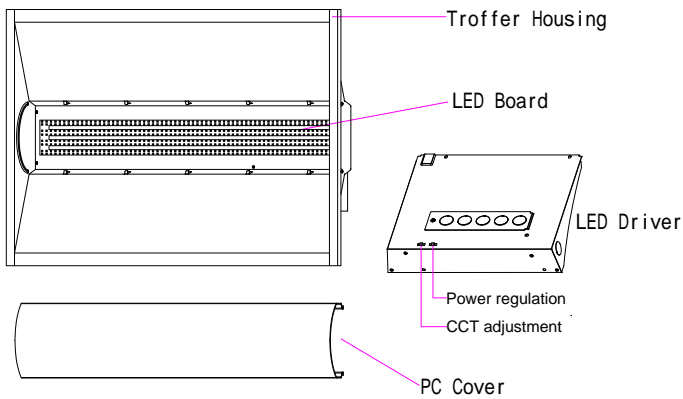

Electric Shock Attention

Ensure the power supply has been cut off before connecting the wire, and all wiring and installation of this product are required to be operated by professionals.

INSTALLATION INSTRUCTION

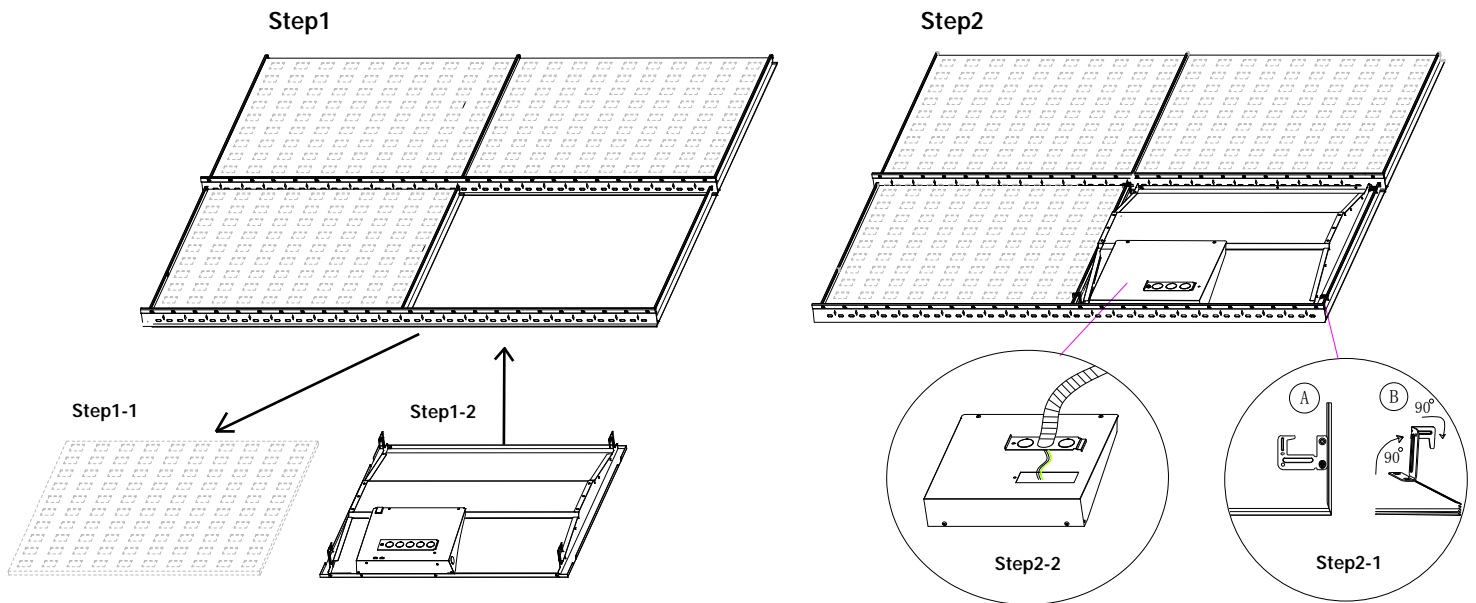

Step 1: Make sure of all the power is off before installing. Remove the one ceiling tile that you need to install light fixture on. Then place the light fixture on the T-bar carefully and make sure it is correctly in place and secure.

Step 2: Lift the 4 buckles on the back of the panel up by 90° then bend the top part of the buckles 90° towards the direction where you can anchor the light fixture to the T-bar.

Step 3: Open the driver's junction box and connect the AC wire to the driver correctly (L=black & N=white)

Warning:

Ensure the power supply has been cut off before connecting the wire, and all wiring and installation of this product are required to be operated by professionals.